

Foundation



**Central Virginia**  
DRAFTING AND DESIGN



MATTHEW TAYLOR  
434.213.6832  
CentralVirginiaDD@gmail.com

Project Name and Address:  
Avery Plans  
Johnson Mountain Rd  
Huddleson Va 24104

DRAWINGS PROVIDED BY:  
Central Virginia Drafting and Design LLC  
Matthew Taylor  
305 Hunters Creek Rd  
Forest Va 24551  
434-213-6832

DATE:

1/10/23

SCALE:

1/4" = 1'-0"

SHEET:

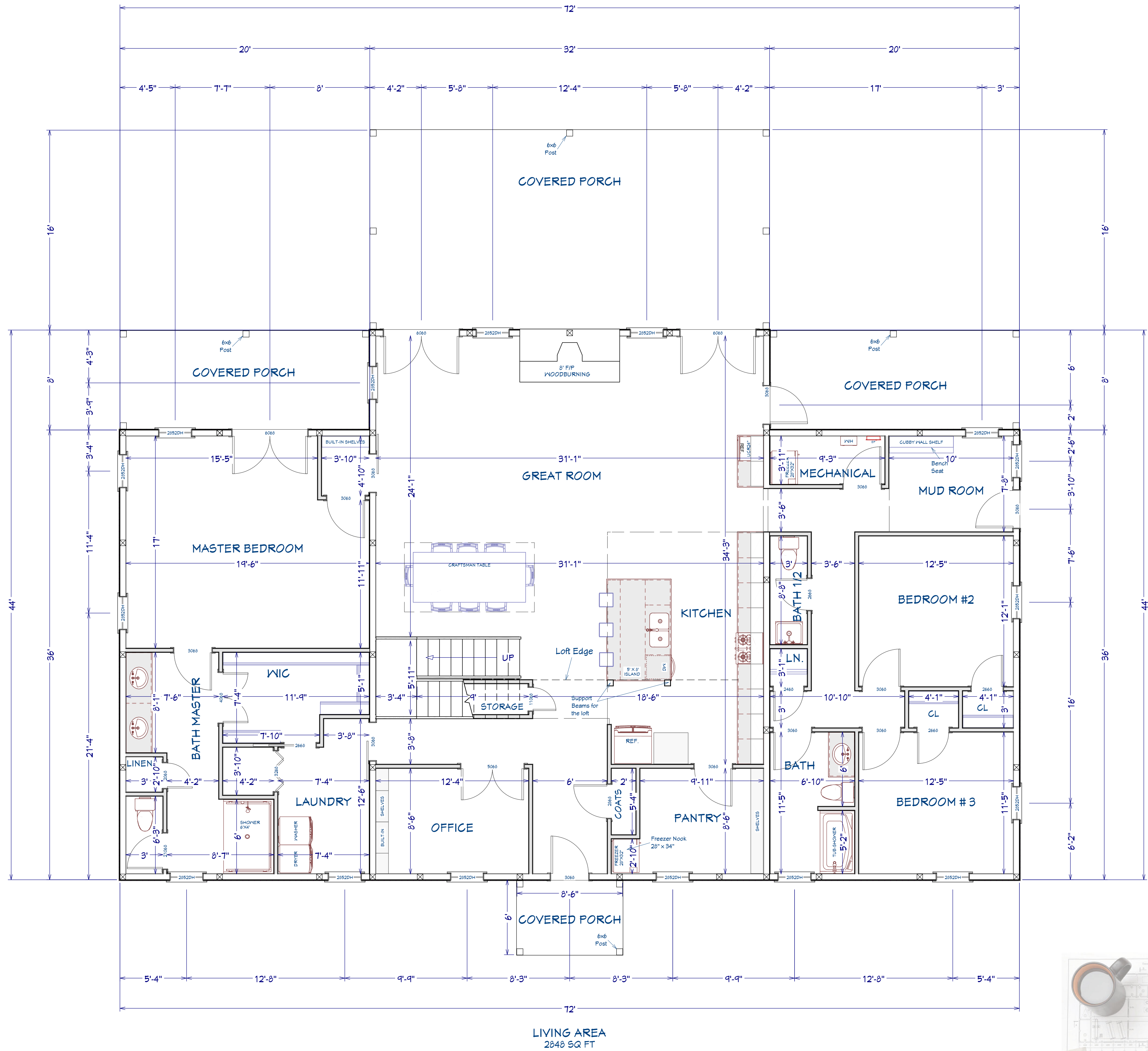

LIVING AREA  
2846 SQ FT

1st Floor



# Avery Plans

Project Name and Address:  
Avery Plans  
Johnson Mountain Rd  
Huddleson Va 24104

DRAWINGS PROVIDED BY:  
Central Virginia Drafting and Design LLC  
Matthew Taylor  
305 Hunters Creek Rd  
Forest Va 24551  
434-213-6832

DATE:

1/10/23

SCALE:

1/4" = 1'-0"

SHEET:

2



Project Name and Address:  
Avery Plans  
Johnson Mountain Rd  
Huddleson Va 24104

DRAWINGS PROVIDED BY:  
Central Virginia Drafting and Design LLC  
Matthew Taylor  
305 Hunters Creek Rd  
Forest Va 24551  
434-213-6832

DATE:

1/10/23

SCALE:

1/4" = 1'-0"

SHEET:

3

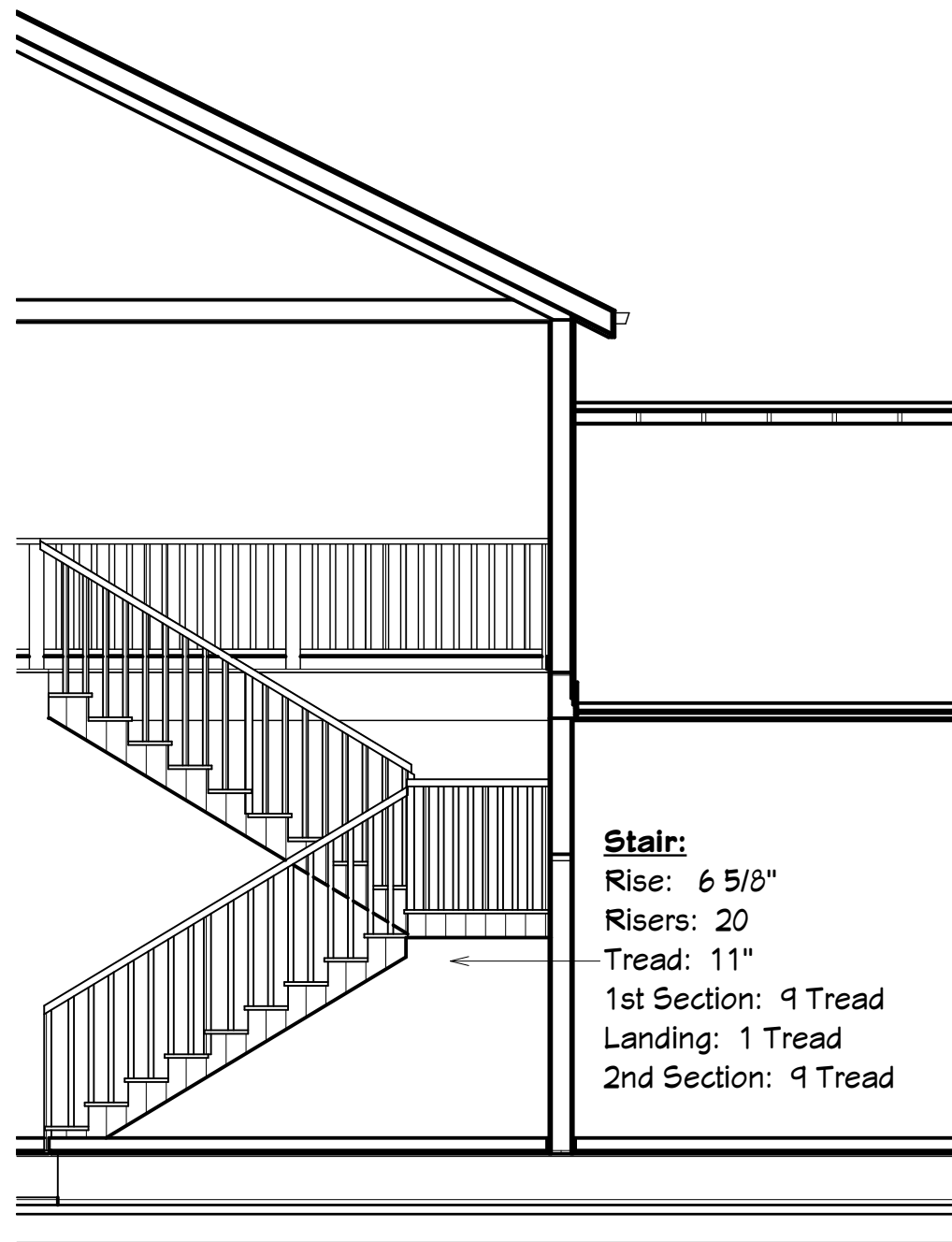

Stair Section

NO CONSTRUCTION REVIEW

It is agreed that the professional services of the design group/engineer do not extend to or include the review or site observation of the contractors work or performance. It is further agreed that the owner will defend, indemnify and hold harmless the design group/engineer from any claim or suit whatsoever, including but not limited to all payments, expenses or costs involved, arising from or alleged to have arisen from the contractors work to the design intent and the contract documents.

PROTECTION OF EXISTING UTILITIES

All existing underground utilities shall be physically located by the contractor or his agent prior to the beginning of construction in the vicinity of utilities. this plan does not represent that all existing utilities are shown or that those shown are correctly located. It is the contractors responsibility to contact each utility company, call Miss Utility (1-800-552-7001), dig test pits, and take whatever steps are necessary to accurately locate and protect all existing utilities. No construction shall proceed until the accurate locations of all utilities have been made and it has been determined by the contractor that construction can be accomplished in accordance with these plans without utility conflicts. In the event that conflicts exist, the owner and engineer shall be notified immediately.

GENERAL NOTES:

- This project has been designed under the latest edition of the Uniform Statewide Building Code of Virginia.
- All work shall be in accordance with all applicable local and state codes, ordinances and regulations.
- All materials shall be handled, stored and installed in strict compliance with the manufacturers printed literature.
- On site verification of all dimensions and conditions shall be the responsibility of the general contractor and his sub-contractors. noted dimensions take precedence over scale.
- The contractor shall compare and coordinate all drawings; when in the opinion of the contractor, a discrepancy exists he shall promptly report it for proper adjustment before proceeding with the work.
- The design group/engineer accepts no responsibility for changes or deviations from these plans unless made by prior signed letter or change order.
- The design group/engineer shall not be responsible for the means, methods, procedures, techniques, or sequences of construction, nor shall the design group/engineer be responsible for the contractors failure to carry out the work in accordance with the contract documents and these drawings.
- The services to be performed by the design group/engineer under this agreement are solely for the benefit of the owner. Nothing contained herein shall confer any rights upon or create any duties on the part of the design group / engineer toward any persons not a party to this agreement including but not limited to any contractor, sub-contractor, supplier or the agents, officers, employees, insurers, or sureties of any of them.
- In the event certain features of the construction are not fully shown on the drawings, their construction shall be of the same character as for similar conditions that are shown or noted.
- All debris shall be placed in a centralized location away from the work area.
- The general contractor shall be responsible for initiating, maintaining and supervising all safety precautions and programs in connection with the construction of this tenant improvement and the performance of this contract inclusively.

Notes:  
All interior dimensions are to the inside face of the stud.  
All exterior dimensions are to the center line of the windows and doors.

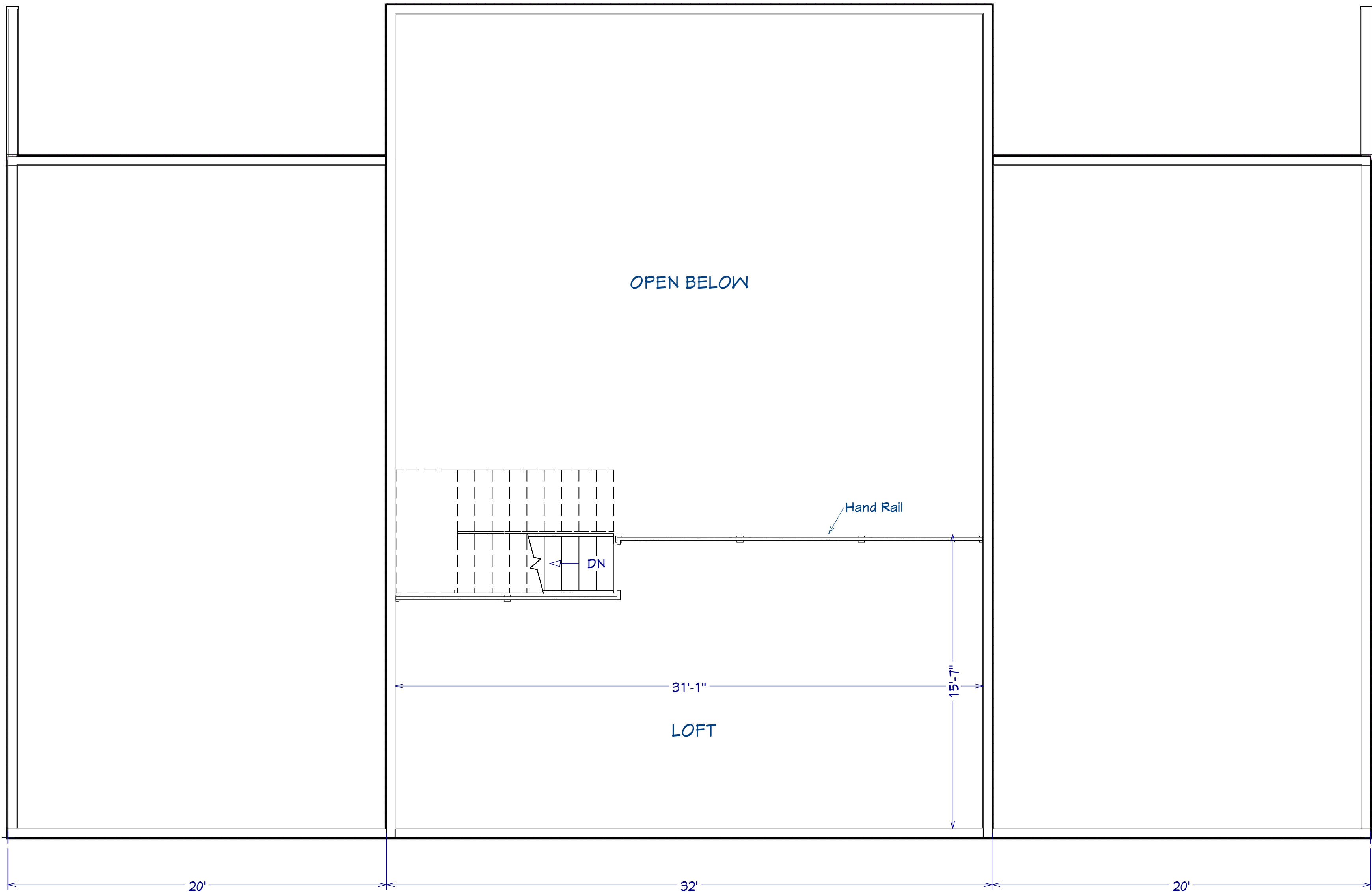

LIVING AREA  
476 SQ FT

2nd Floor

