

#### SPREAD FOOTING SCHEDULE"

- A 42" SQ X 10" Thick W/ #4 bars @ 8" O.C. E.W.
- B 54" SQ X 12" Thick W/ #4 bars @ 8" O.C. E.W.
- C 42" SQ X 12" Thick W/ #4 bars @ 8" O.C. E.W.
- D 36" SQ X 10" Thick W/ #4 bars @ 8" O.C. E.W.
- E 30" SQ X 10" Thick W/ #4 bars @ 8" O.C. E.W.

#### SPECIFIC NOTES:

- Refer to soil report prepared by Soil Tech, Inc. dated September 7, 2005 for sub-grade preparation & construction requirements to achieve soil bearing capacity = 1,500 PSF
- Foundation system design based on loads from super structure provided by Haven Homes.
- Beams / Headers shown on this sheet were designed based on loads provided by Haven Homes.
- Foundation information shown on this sheet shall be coordinated with sheets certified by Registered Architect & Structural Engineer in the state of Virginia
- Soil bearing capacity of 1,500 PSF was used to design foundation systems based on sub-grade preparation required per Soil Tech report dated September 7, 2005
- Refer to approved plot plan for drainage and utility requirements.
- Haven Homes shall ensure that this foundation design is coordinated with superstructure design both on drawings and in the field. Haven Homes to approve in-place foundation system prior to placement of modular components.
- Refer to architectural basement floor plan for room and wall locations.
- Soil and foundation wall heights vary, but construction requirements will remain typical.

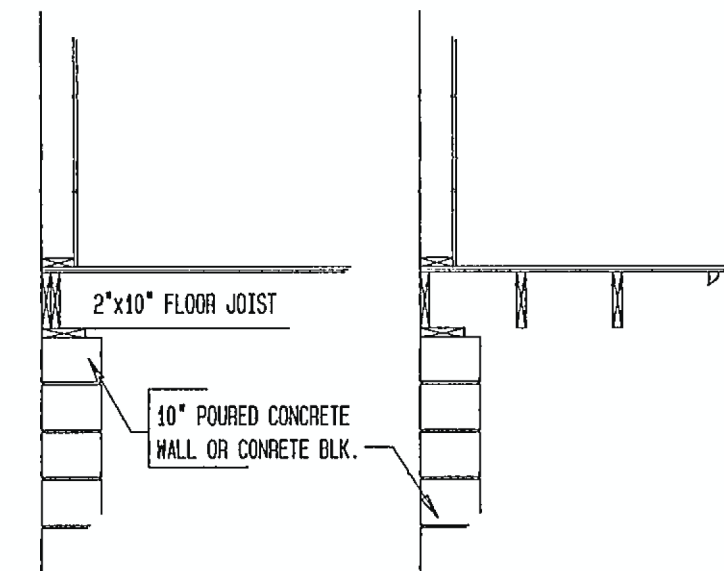

TYPICAL EAVE WALL TYPICAL END WALL

WHEN 2"x10" FLOOR JOIST ARE USED, THE STILL PLATE (BOND TIMBER) IS TO BE INSTALLED FLUSH WITH THE OUTSIDE FACE OF THE FOUNDATION WALL, TYPICAL BOND TIMBER SIZE -2"x8" WITH 2"x10" FLOOR JOIST.

#### BOND TIMBER DETAIL

2"x10" FLOOR JOIST -NO FOAM

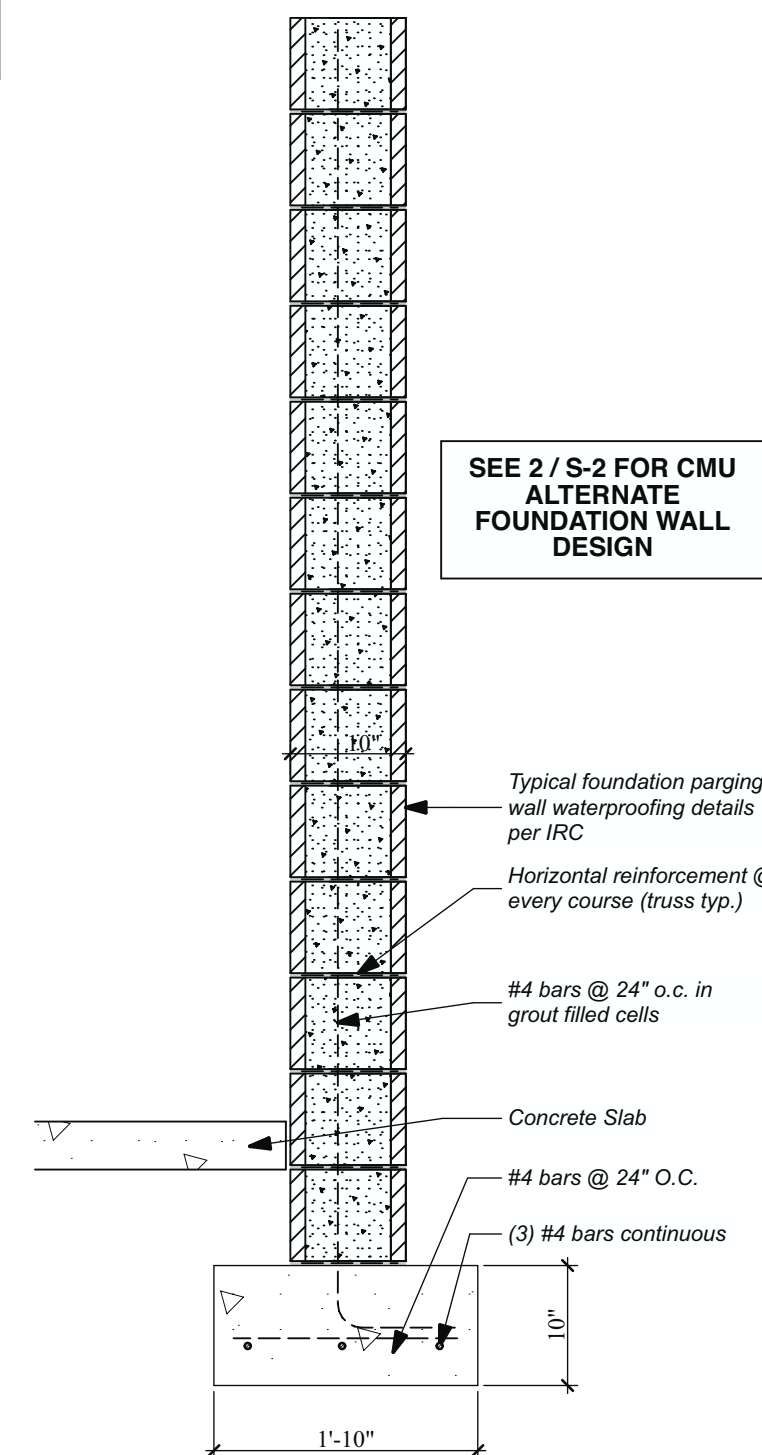

**CRC Design & Assoc.**

4733 South 6<sup>th</sup> Street  
Arlington, VA 22204  
PHN: (703) 620-0263 FAX: (703) 920-0263

**S-1**

SHEET

SCALE  
1/4" = 1' -0"

DATE  
Tuesday, September 18, 2007

DRAWN BY  
PGH

FOUNDATION PLAN & FOUNDATION WALL SECTION

REVISIONS

CUSTOMER NAME:  
CRC Design Associates  
Androus Residence

CUSTOMER ADDRESS:  
702 EMBURY DRIVE  
ALEXANDRIA, VA.

BUILDER:  
ANDROUS DEV.