

INTERMITTENTLY OPERATING	BATHROOMS	KITCHENS
	50 CFM	100 CFM
CONTINUOUS OPERATION	20 CFM	25 CFM

A SMOKE DETECTOR SHALL BE INSTALLED IN EACH HABITABLE ROOM. A SMOKE DETECTOR SHALL BE CENTRALLY LOCATED ON EACH FLOOR. AN ADDITIONAL SMOKE DETECTOR SHALL BE INSTALLED IN EACH LOCATION WHERE THERE IS A CEILING HEIGHT CHANGE GREATER THAN 24" SMOKE DETECTORS ARE TO BE 110V, INTERCONNECTED WITH A BATTERY BACKUP.

CO² CO DETECTORS TO BE INSTALLED OUTSIDE OF EACH SEPARATE SLEEPING AREA.

1. FOUNDATION PENETRATION SHALL BE 1/2" OF THE FOUNDATION AREA AND SHALL BE VENTED BY A MINIMUM OF 1/2" OF THE FOUNDATION AREA. THE FOUNDATION SHALL BE VENTED BY AS PRACTICAL AND ARRANGED TO PROVIDE CROSS CIRCULATION OF AIR AT LEAST TWO SIDES. THEER SHALL BE COVERED WITH CORROSION RESISTANT WEIR 1/4" THICKNESS.
2. GROUND SPACE UNDER FLOOR SHALL BE AT LEAST 18" AND A MIN. OF 12" UNDER BOTTOM OF COLUMNS. UNDER FLOOR AREA SHALL BE PROVIDED WITH A MIN. OF 18"x24" ACCESS HOLE.
3. PROVIDE 1/2" OF FOUNDATION WALL.
4. ALL WOOD IN CONTACT WITH CONCRETE SHALL BE PRESURE TREATED WOOD OF ANY SPECIES.
5. DISMISHER TO HAVE AIR CAP
6. HO WATER MAIN PRESSURE RELIEF VALVE PIPE DOWN TO OUTSIDE. DRAIN PIPE DOWN WITHIN 2' ABOVE GROUND PAVING DOWN TO DRAINAGE.
7. FLOOR ACCESS TO BE READILY ACCESSIBLE. MIN SIZE 22"x30" WITH 30" UNOBSTRUCTED HEADROOM.
8. HANDRAIL SHALL BE PROVIDED ON TWO SIDES OPEN AND CONTINUE ON ONE SIDE ONLY. HANDRAIL SHALL BE 36" HIGH. HANDRAIL SHALL RETURN TO THE WALL OR SHALL BE CONTINUED IN A NEWELL POST. THESE SHALL HAVE A SMOOTH SURFACE WITH NO SHARP EDGES.
9. USED SPACE UNDER STAIRS, WALLS AND CEILING TO HAVE 5/8" X ONE
10. FIREPROOF STAIRWAYS BETWEEN STAIRWELLS AND RUN BETWEEN STAIRS.

- [illegible]

SCALE: 1/4" = 1'-0"

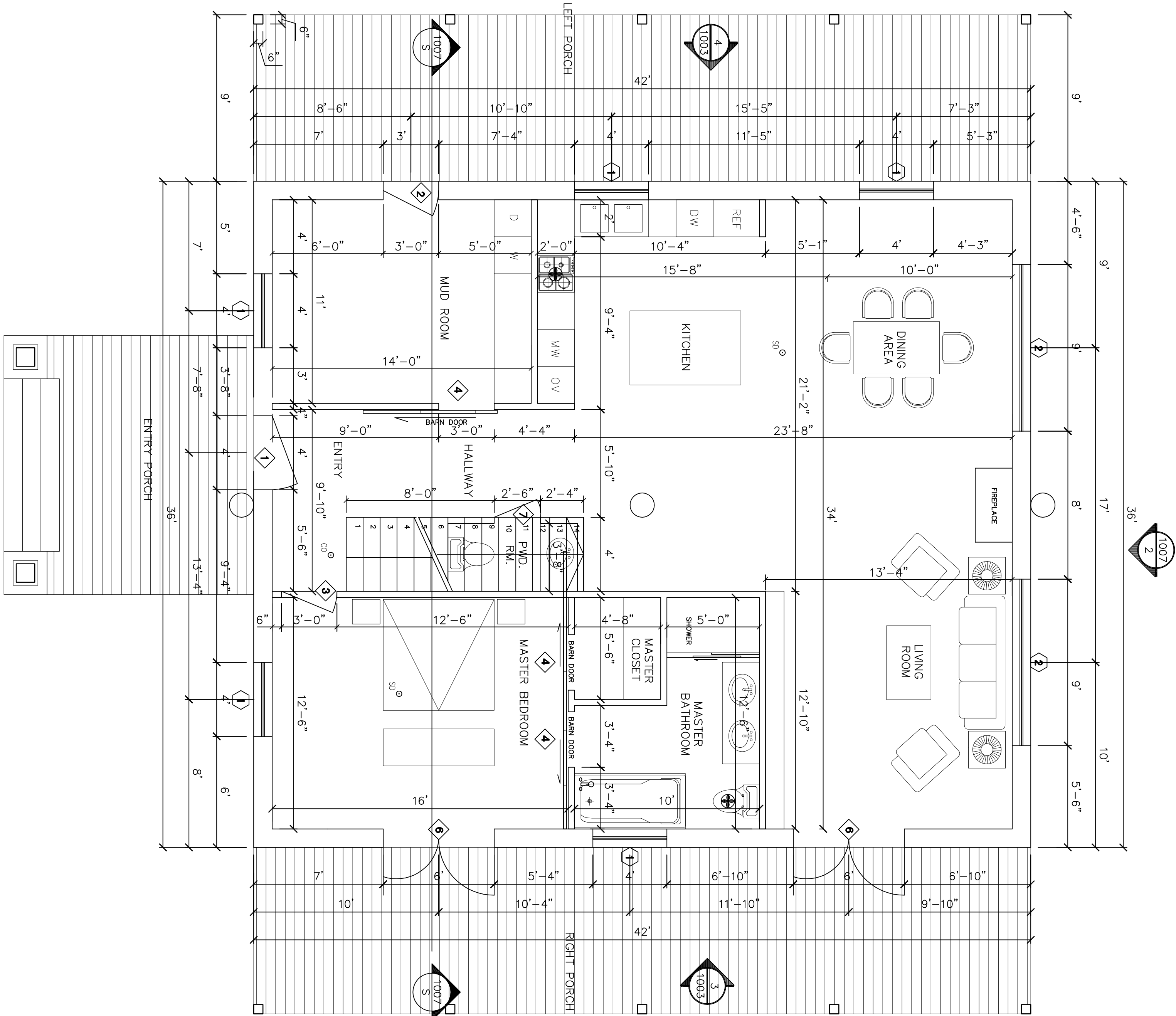

1001 SCALE: 1/4" = 1'-0"

